

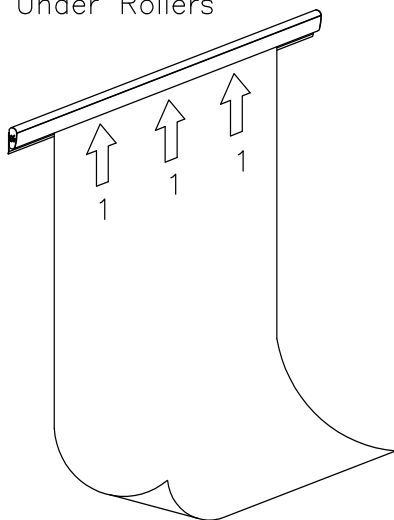

# Best-Bite 505

TO USE:  
Slide Paper Up  
Under Rollers



TO REMOVE PAPER:  
Lift Paper Up And  
Slide Out

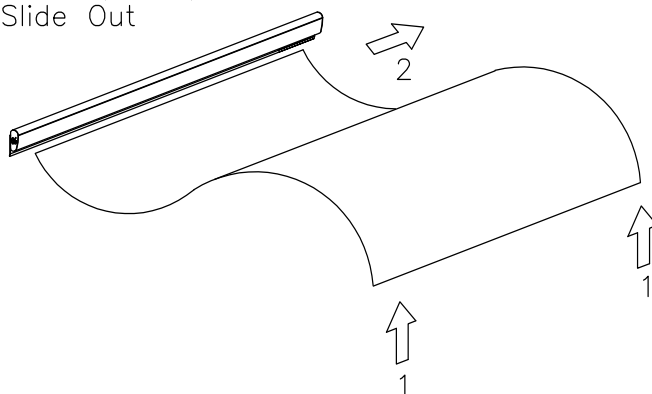

## Part List

P1



Best-Bite

1 EA

## Hardware List



Mounting Bracket 2, 3 or 4 EA

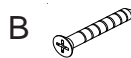

Screw 2, 3 or 4 EA



Screw Anchor-Concrete 2, 3 or 4 EA



Magnet Strip 2, 3 or 4 EA



Double Sided Tape 1, 2, 3, 4, or 6 EA

***Should you require assistance  
during assembly, please call our  
Customer Service Department  
Monday- Friday 8 a.m.-5 p.m. CST  
1-800-749-2258***

## There are Three Ways to Install Your New Best-Bite.

### Option One

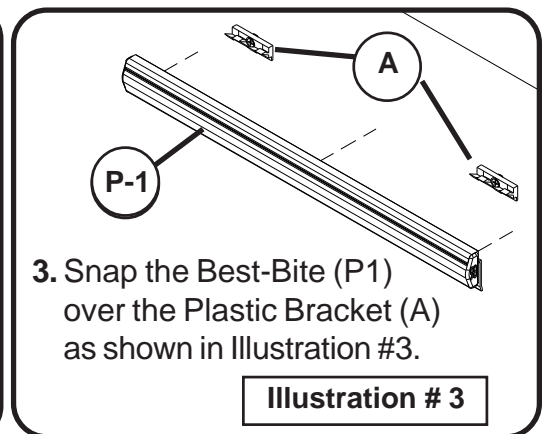
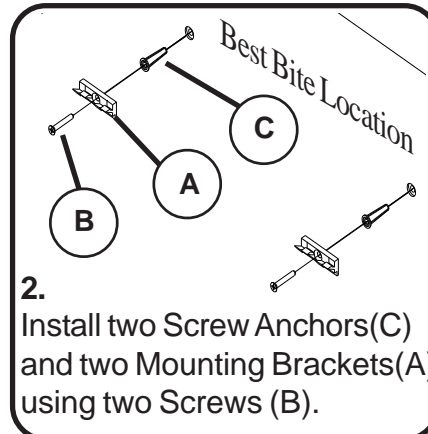
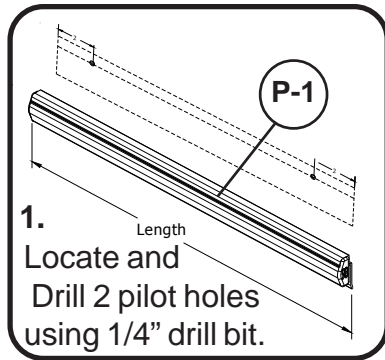

### Option Two

1. Peel off protection paper from one side of Double Sided Tapes (E). See Illustration #4

2. Wipe off the back of Best-Bite (P-1) to remove all particles. Place the tape's peeled sides on to the back of the unit in even spaces, and remove the other protection paper from the Double Sided Tapes (E). See Illustration #5.

3. Wipe off the surface where Best-Bite (P-1) will be installed. Press the unit with the exposed Double Sided Tape against the wall surface. See Illustration #6.

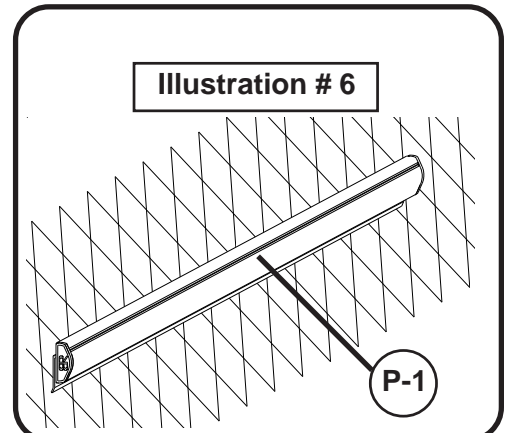
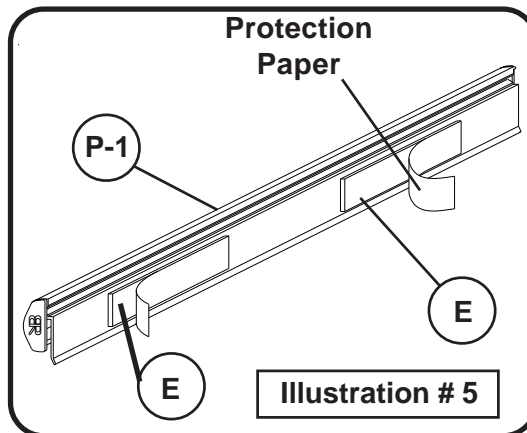
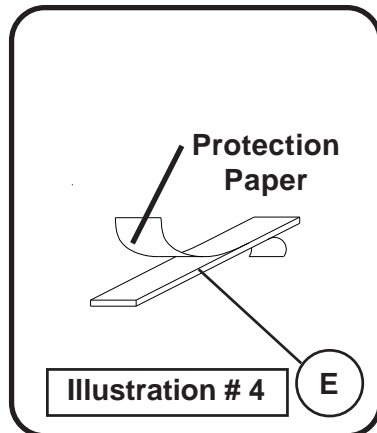

### Option Three

**NOTE: This option is not recommended for mounting 6' and 8' Best-Bites.**

1. Peel off protection paper of the Magnet Strips (D). See Illustration #7

2. Wipe off the back of Best-Bite (P-1) to remove all particles. Place the peeled side of the Magnet Strips (D) on to the back of Best-Bite (P-1). At this point you can place your Best-Bite on any surface that accepts magnets. See Illustration #8.

