

EASY HEIGHT
ADJUSTMENT
WITH SELF
THREADING
KNOB!

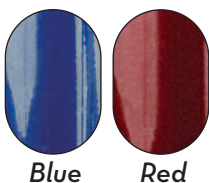

Blue

Red



301PSBN

SEE PAGE 52 & 53 FOR
REPLACEMENT SEATS.

Junior Aluminum Rollator, Padded Seat, 6" Casters with Loop Locks

301PSBN Blue, (Has replaced 301B), 1/cs

301PSRN Red, (Has replaced 301R), 1/cs

FEATURES:

- 6" casters with soft-grip tires are ideal for indoor and outdoor use.
- Tool Free removable padded back rest with cover for comfort.
- 18" floor to seat height.
- Special loop lock made of internal aluminum casting operates easily and ensures safety.
- Manufactured with wrap-around welds providing additional strength and support.
- Comfortable padded seat.
- Handles are adjustable in height.
- Comes standard with pouch (item # 804).
- Optional basket (item # 301-B) available.
- Easy, one hand folding.
- Limited Lifetime Warranty.

Winnie, Mimi Lite Aluminum Rollator, Padded Seat, 6" Casters with Push Lock

510 Dark Blue, 1/cs

515 Red, 1/cs

FEATURES:

- Push down lock operates easily and ensures safety.
- 6" casters with soft-grip tires are ideal for indoor and outdoor use.
- Tool Free removable padded back rest with cover for comfort.
- Comes standard with carry pouch (item #804).
- Handles are adjustable in height.
- Comfortable padded seat with zippered inner pouch.
- Optional basket available (item # 830).
- Easy, one hand folding.
- Limited Lifetime Warranty.

EASY HEIGHT
ADJUSTMENT
WITH SELF
THREADING
KNOB!



510

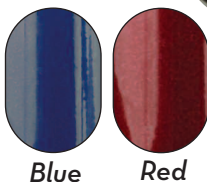

Blue

Red

PUSH DOWN REAR WHEEL LOCKS USE A
SPRING TO ALLOW THE LARGE RUBBER TIP
TO HOLD THE ROLLATOR IN PLACE!

SPECIFICATIONS

Important Notice: Item numbers that display an asterisk () reflect an item that will be discontinued or package change.

Item #	Handle Height (highest)	Handle Height (lowest)	Unit Width	Unit Length	Seat (depth)	Seat (width)	Seat (height)	Product Weight	Carton Shipping Weight	Weight Limit
301PS	33"	28"	24.5"	20"	14"	15.75"	18"	12 lbs.	16 lbs.	300 lbs.
MIMI-LITE	37"	32"	24"	24"	13"	14"	22"	12 lbs.	16 lbs.	300 lbs.

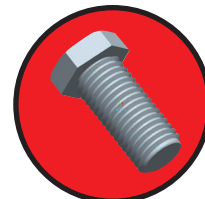

**PARTS
DIAGRAMS
ON PAGE 62**

SEE PAGE 52 & 53 FOR
REPLACEMENT SEATS.

**OPTIONAL BASKET
AVAILABLE
MODEL # 830**

SEE PAGE 55