

TRANSPORT CHAIR & ROLLATOR IN 1 PRODUCT!



LOCK KNOB ASSURES PROPER CLOSURE!

795BU

COMES WITH PADDED SEAT WITH POUCH!



FOLD DOWN FOOT REST FOR USE AS TRANSPORT CHAIR!

HEIGHT ADJUSTABLE FOOTREST WITH SAFETY WHEEL PREVENTS TIPPING!

Duet Transport Chair/Rollator

795B	Blue, 1/cs
795BK	Black, 1/cs
795BU	Burgundy, 1/cs

FEATURES:

- Combines the features of a rollator and transport chair in one unit. An individual can ambulate independently or be pushed safely by a care giver.
- The Duet has locking flip up armrests and a flip down footrest to aid the user while the Duet is used in the transport chair mode. A safety lock release is used to store the arms and a velcro strap is used to store the footrest while using the Duet for ambulation.
- The tool-free two position contoured padded back rest is reversible depending on whether you are using the Duet in an ambulatory or transport chair mode.
- Easy release loop locks.
- Comfortable padded seat with a large underseat pouch for safe storage of personal items. Inside the pouch is a handle to aid with the folding.
- The folding frame has a lock out feature to insure the unit stays open while in use and insures the unit will stay folded during transport.
- Large 8 inch casters are used for both indoor and outdoor activities.
- Weighs only 19 lbs.
- Limited Lifetime Warranty.

SEE PAGE 52 & 53 FOR REPLACEMENT SEATS.

SPECIFICATIONS

Important Notice: Item numbers that display an asterisk () reflect an item that will be discontinued or package change.

Item #	Overall Width (open)	Overall Height	Seat To-Floor Height	Handle Height Range	Back Height	Width Seat	Depth Seat	Overall Length	Product Weight	Carton Shipping Weight	Weight Limit
DUET	25.5"	37"	21"	31.5" - 37"	36"	13.5"	13"	26"	19 lbs.	23 lbs.	300 lbs.

①



②



③



NEW FOLDABLE ARMREST WHEN USED AS A TRANSPORT CHAIR!



EASY HEIGHT ADJUSTMENT WITH SELF THREADING KNOB.

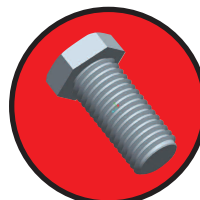

PARTS
DIAGRAMS
ON PAGE 65



Blue Burgundy Black