

## lifetime limited warranty

Your Drive brand product is warranted to be free of defects in materials and workmanship for the lifetime of the original consumer purchaser.

This device was built to exacting standards and carefully inspected prior to shipment. This Lifetime Limited Warranty is an expression of our confidence in the materials and workmanship of our products and our assurance to the consumer of years of dependable service.

In the event of a defect covered by this warranty, we will, at our option, repair or replace the device.

This warranty does not cover device failure due to owner misuse or negligence, or normal wear and tear. The warranty does not extend to non-durable components, such as rubber accessories, casters, and grips, which are subject to normal wear and need periodic replacement.

If you have a question about your Drive device or this warranty, please contact an authorized Drive dealer.



© 2006 Medical Depot, Inc. All rights reserved.  
Drive is a trademark of Medical Depot, Inc.  
Port Washington N.Y. 11050 USA Made in China

## bariatric over bed table

item # 13080

# assembly instructions

1. Lay Top (#6) on table or floor with Top Support Bracket (#7) as shown
2. ELEVATE TRIP HANDLE (#8) TO APPROXIMATELY A 45°ANGLE. Insert Column (#4) into Top Support (#7), making sure the rectangular notches are aligned with the Top Bracket (#7) embossing (See Fig.2). Make sure that the Trip Handle (#8) tab is in the Trip channel in the Column (#4) (See Fig. 3). Fasten using 3/4" long bolts (#9) and lock washers (#10).
3. Lay the Base (#2) on a table or floor and install Casters (#3).
4. Install Base (#2) to the Column (#4) with Casters pointing up. Tighten the hex-head bolts (#1) through the lock washers (#10) and base (#2).
5. Set the table upright on its casters.
6. Remove the black shipping screw (#5) from front of Column (#4) and discard. Assembly is complete.

**WEIGHT CAPACITY: 500 LBS**

## CAUTION--SPRING LOADED ASSEMBLY

Do not remove the black shipping screw before completing assembly steps 1- 5. Removing the shipping screw before this can result in personal injury and spring damage.

## Tools Necessary For Assembly:

Phillips Screwdriver  
9/16" Wrench

FIGURE 1

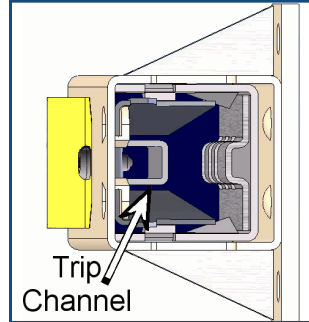

FIGURE 2

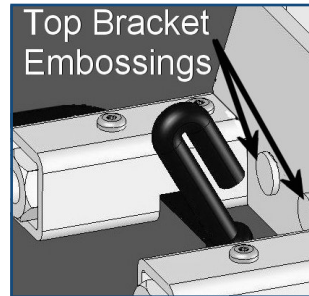
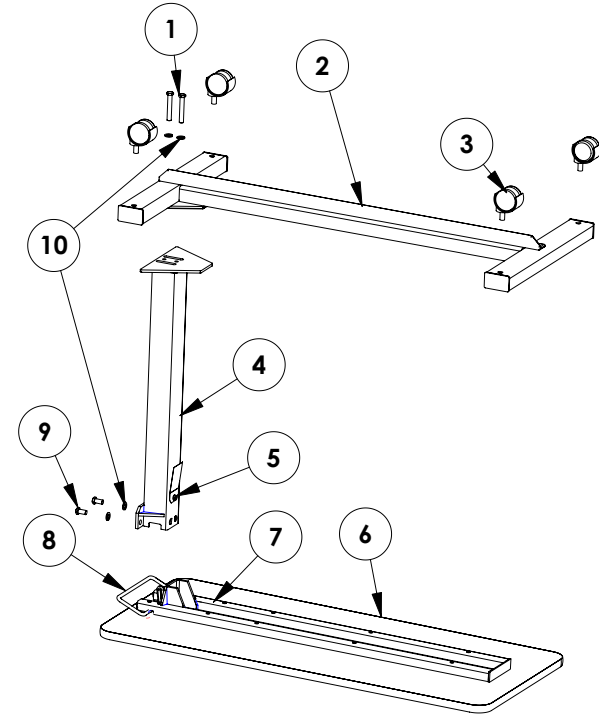
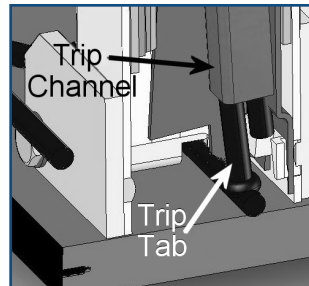

FIGURE 3



# operating instructions

## TO ELEVATE THE TABLE:

Push upward at any position on the underside of the Top (#6), until the top has reached the desired height.

## TO LOWER THE TABLE:

Squeeze the Trip Handle (#8) to release the column, and push down on the top (#6) until the desired height is reached.