



Voyager[™] Pro Nebulizer

 **CAUTION:** Federal (US) Law restricts this device to sale by or on the order of a physician.

REF. 18018

Getting acquainted	02
Safety information and warnings	02
Important information on the device	07
· Accessories	
· Protecting against leaks	
· Automatic switch-off	
Know Your Voyager™ Pro Nebulizer	08
Initial use	09
· Before using the device for the first time	
· Assembly	
· Battery Replacement	
· Operating the device with the switching power supply	
Operation	12
· Preparing the nebulizer	
· Filling the nebulizer	
· Closing the nebulizer	
· Fitting accessories	
· Inhaling correctly	
Cleaning and disinfection	15
· Warning	
· Cleaning	
· Disinfection	
· Disassembly	
· Drying	
· Material resistance	
· Storage	
How to replace the mesh nebulizer	20
Troubleshooting	21
Specifications	23
Manufacture Date	24
Warranty Information	25

Getting acquainted

Area of application

The Voyager™ Pro nebulizer is a vibrating mesh nebulizer for treating the upper and lower respiratory tract.

The nebulization and inhalation of medication prescribed or recommended by a doctor can prevent against diseases of the respiratory tract, treat the side effects of these disorders and accelerate healing.

For more information on possible applications, consult your doctor or pharmacist. The device is suitable for inhalation at home or on the move. Medicines should only be inhaled when instructed by a doctor.

Inhalation should be performed in a calm and relaxed atmosphere. Inhale slowly and deeply to enable the medicine to reach the small bronchi deep into the lungs. Exhale normally.

Safety information and warnings

Warning

- Before use, ensure that there is no visible damage to the device or accessories. When in doubt, do not use the device and contact your equipment provider.
- Using the device is not a substitute for consultation with or treatment from a physician. Whenever you have any pain or illness, always contact your physician first.
- If you have health concerns of any kind, contact your general practitioner!
- When using the nebulizer, always follow the basic hygiene procedures.
- Always follow your doctor's instructions regarding the type of medicine to be used and the dose, frequency, and duration of inhalation.
- Only use medicines that have been prescribed or recommended by your doctor or pharmacist.

- If the device does not function correctly or if you begin to feel unwell or feel pain, stop using the device immediately.
- During use, hold the device away from the eyes, as some nebulized medicines may cause damage to the eyes.
- Do not operate the device in the presence of flammable gases.
- Do not use the device near electromagnetic transmitters.
- This device is not intended to be used by children or persons with restricted physical, sensory (e.g. insensitivity to pain) or mental abilities or persons lacking in the required experience or knowledge for safe operation of the device, unless supervised or instructed by a person responsible for their safety.
- Keep children away from packaging materials (risk of suffocation).
- Do not use attachments that are not recommended by the manufacturer.
- Do not dip or submerge the device into water and do not use it in wet rooms. Do not allow any liquid to penetrate the device.
- Protect the device from strong impacts.
- Do not use the device if it has fallen or been dropped on the floor, been exposed to extreme humidity or is otherwise damaged. In case of doubt, contact our customer service department or your local dealer.
- The Voyager™ Pro Nebulizer must only be operated along with the appropriate Drive Medical accessories. The use of other accessories can impair therapeutic efficiency and may damage the device.
- Remove the batteries from the device if you will not be using it for an extended period. Leaking batteries may damage the device.
- Always keep mesh nebulizer in the device. A drop or fall in 4 in (10 cm) height may cause it broken or damage.
- Always dry up the device, including mesh nebulizer and medicine container. Oxides may block the mesh hole and impair the nebulizer efficiency.

Important

- Power loss, sudden faults or other unfavorable conditions may render the device unusable. You are therefore recommended to keep a spare device or replacement medicine (as agreed with the doctor).
- The device must be stored away from sources of heat.
- Do not use the device in a room in which a spray has previously been used. If this is the case, ventilate the room before commencing treatment.
- For reasons of hygiene, each user should use their own set of accessories (mesh nebulizer, mask and mouthpiece).
- Store the device in a location protected against environmental influences. The device must be stored in the specified ambient conditions.
- Do not use any medicines in powder (even if dissolved).
- Do not shake the nebulizer, as this may cause liquid to leak, thereby damaging the device.

General notes

Important

- Use the device only:
 - On humans
 - For its intended purpose (aerosol inhalation) and in the manner described in these instructions for use.
- Any improper use can be dangerous!
- In acute emergencies, first aid takes priority.
- In addition to medicines, use only a saline solution.
- This device is not intended for commercial use, but only for individual use.

Before using the device for the first time

Important

- Before you use the device for the first time, remove all packaging materials.
- Protect the device from dust, dirt and moisture.
- Do not use the device in very dusty environments.
- Before use, ensure the device and accessories are at room temperature.
- Switch the device off immediately if it is defective or malfunctioning.
- The manufacturer shall not be held liable for damage or injuries caused by improper or incorrect use.

Notes on handling batteries

- Keep batteries out of the reach of children. Children can put batteries in their mouths and swallow them. This can cause severe harm to their health. In this case, consult a physician immediately!
- Normal batteries must not be recharged, heated or thrown into open flame (risk of explosion).
- Leaking batteries may damage the device. If you do not intend to use the device for prolonged periods, remove the batteries from the battery compartment.

Caution

Leaking or damaged batteries can cause burns upon contact with the skin. When removing such batteries, wear suitable protective gloves.

Repairs

Note

- Never open or attempt to repair the device by yourself, as otherwise proper function is no longer guaranteed. Failure to observe this regulation shall void the warranty.
- If you need to have the device repaired, contact your equipment provider.

Important information on the device

Accessories

The safe functioning of the device can only be guaranteed if the accessories recommended by the manufacturer are used.

Caution

Protecting against leaks

When filling the medicine container with medicine, ensure that you do not exceed the maximum mark (8 ml). The recommended filling amount is between 2 and 8 ml.

During use, you can tilt the device up to a maximum angle of 45° in any direction, without impairing its nebulizing function or success of the treatment. However, spraying only takes place if the substance to be sprayed is in contact with the mesh. If it is not, spraying stops automatically.

If this happens, please try to hold the device as upright as possible.

Automatic switch-off

The device has an automatic switch-off function. To prevent damage to the mesh, the device switches off automatically when the liquid has been almost used up.

Do not use the device if the medicine container or water tank is empty.

The device switches off automatically if the substance to be sprayed is no longer in contact with the mesh.

Know Your Voyager™ Pro Nebulizer

Overview

1. Cover
2. Medicine container
3. Mesh Nebulizer
4. On/Off button
Blue : device ready
Yellow : change batteries
5. Battery compartment
6. Mini USB port

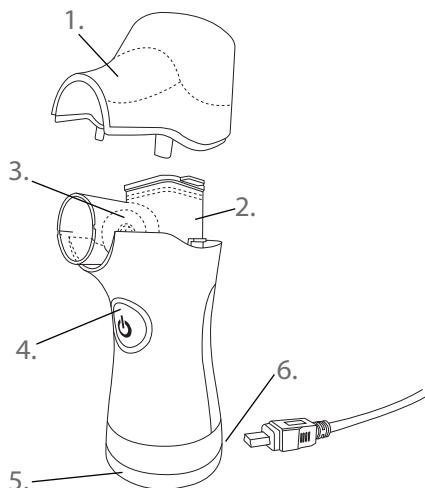

Overview of accessories

7. Adult mask
8. Child mask
9. Mouthpiece
10. Connecting piece
11. AAA Battery x 4
12. AC Adapter
13. USB cable
14. Soft Pouch

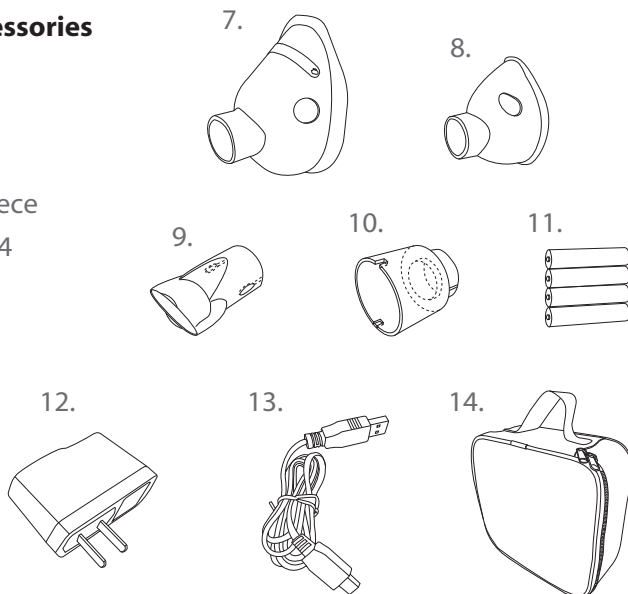

Initial use

Before using the device for the first time

Note:

- Before first use, the nebulizer and the accessories should be cleaned and disinfected. For more information, see page 15.

Assembly

Remove the device from the packaging.

- If not already fitted, fit the mesh nebulizer onto the neck of the container, and lock the neck in place by turning it counterclockwise until the gold-colored contact electrodes are facing down wards.

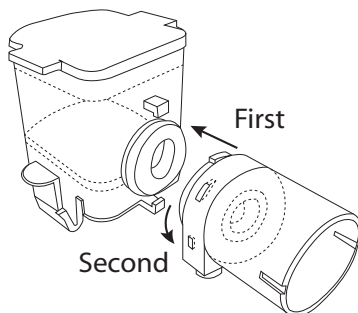

- Place the container with fitted mesh firmly onto the housing or base of the device, until you hear it click into place on the left and right.

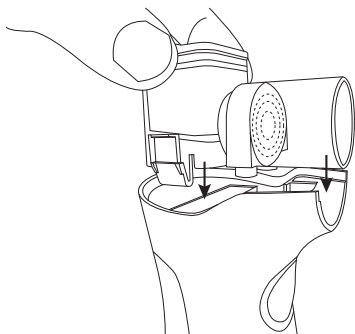

Battery Replacement

1. Turn the device upside down, and follow the sign on the bottom cover to "Open" the bottom cover.
2. Take off the bottom cover, and take off the old batteries, and replace four new AAA batteries.

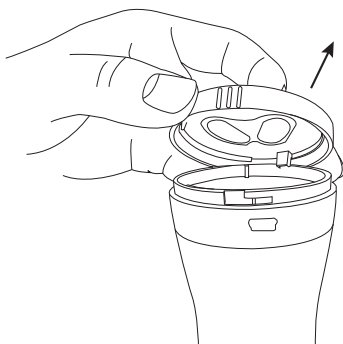
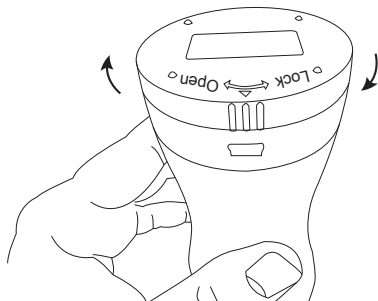

3. Align the three lines with the groove to cover over.
4. Follow the sign on the bottom cover to "Lock" the bottom cover.

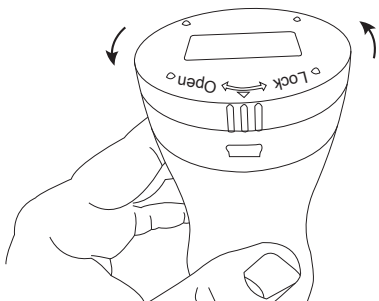
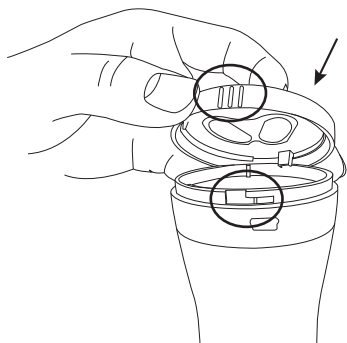

Note:

- When changing batteries, ensure that the medicine container is completely empty, otherwise there is a risk of leaks.
- Spraying becomes much less effective when batteries are weak; therefore, when the yellow LED lights up, replace all four batteries.

Operating the device with the AC Adapter

Connect the USB cable and AC Adapter, insert the USB cable into mini USB port.
Plug the AC Adapter into an appropriate outlet.

- If not already fitted, fit the mesh nebulizer onto the neck of the container, and lock the neck in place by turning it clockwise until the gold-colored contact electrodes are facing downwards.

Note:

- Lay the cable in such a way that no one can trip over it.
- To disconnect the nebulizer from the USB cable after use, first switch off the device and then remove the USB cable and AC Adapter from the mini USB port.
- The AC Adapter can not be used for charging batteries.

Operation

Preparing the nebulizer

- For reasons of hygiene, it is imperative that the nebulizer and accompanying accessories are cleaned and disinfected after every use. If the therapy requires that different medicines be inhaled one after another, ensure that the nebulizer is rinsed and cleaned after every application.

For details, see **Cleaning and Disinfection** on page 15.

- Remove the cover from the device.

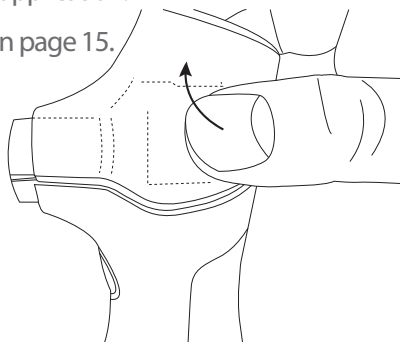

Filling the nebulizer

- Open the medicine container by lifting the clip, and fill the medicine container with an isotonic saline solution or medicine. Do not overfill!

The maximum recommended fill level is 8 ml.

- Use medication only on the advice of a physician, and check the appropriate inhalation duration and quantity for your needs.
- If the recommended dose of the medicine is less than 2 ml, top off this quantity to at least 4 ml using only isotonic saline solution. Viscous medicines may also require dilution. Always follow the instructions of your doctor.

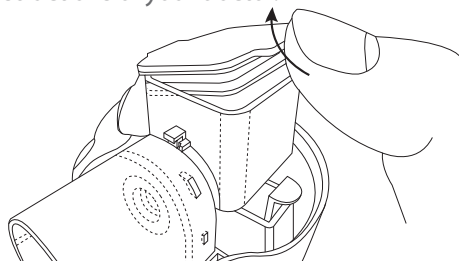

Closing the nebulizer

- Close the lid of the medicine container, and then refit the cover.

Fitting accessories

- When the required accessories (mouthpiece, adult mask or child mask) have been attached to the device, join the device firmly to the assembled medicine container.
- The adult mask and child mask must be fitted using the connecting piece.
- Now place the device to your mouth and close your lips firmly around the mouthpiece. When using either of the masks, place it over the nose and mouth.
- Start the device by pressing the on/off button.
- The spray mist coming from the device and the illuminated blue LEDs show that the device is working perfectly.

Inhaling correctly

- Breathing technique

The right breathing technique is important to ensure that the particles are distributed as widely as possible into the air ways, and that they can enter the air ways and lungs. You must inhale slowly and deeply, hold your breath briefly (5 to 10 seconds) and then exhale quickly.

- You should only use a nebulizer to treat respiratory disorders if advised to do so by your doctor. Your doctor will recommend the medicine, and application for inhalation therapy.
- Certain medicines are only available on prescription.

Note:

You should hold the device as upright as possible. Tilting it very slightly will not, however, affect its function, since the container is leakproof. To ensure that the device functions fully, make sure that you do not tilt it more than 45° in any direction and that the medicine is in contact with the mesh while in use.

Important

Essential oils, cough medicines, solutions designed for gargling, and drops for application to the skin or for use in steam baths are unsuitable for inhalation using a nebulizer. These substances are often highly viscous and can impair the correct function of the device and hence affect the effectiveness of its application in the long term. In the case of oversensitivity of the bronchial system, medicines containing essential oils can sometimes cause acute bronchospasm (a sudden, cramp-like tightening of the bronchi accompanied by breathlessness). Always ask your doctor or pharmacist for advice.

Only use medications prescribed by your doctor, and in the manner directed by your healthcare professional.

- After treatment, switch off the device using the on/off button and the LED blue light will go out.
- Once the inhalant has been fully sprayed out, the device switches off automatically. For technical reasons, a small amount may still remain in the medicine container. Do not use it.
- If applicable, disconnect the USB cable and AC Adapter from the USB cable.

Cleaning and disinfection

Warning

Observe the following hygiene instructions in order to avoid any health risks.

- The nebulizer and accessories are intended for multiple use. Please note that cleaning requirements differ according to the different application areas:

Note:

- Do not clean the mesh or accessories with brushes or similar, as this may cause irreparable damage, which means that the intended result of the treatment is no longer guaranteed.
- For additional requirements regarding the necessary hygienic preparations (hand washing, handling of medicines or inhalation solutions) in high-risk groups (e.g. cystic fibrosis patients), contact your doctor.

Cleaning

The mesh nebulizer and the accessories used, e.g. mouthpiece, mask, connecting piece, etc. must be cleaned with running water and dry them after each use. Once all components are fully dry, gather them together and place them in a dry, sealed container.

- Remove the mouthpiece and any accessories from the nebulizer.
- Add 4 ml of clean water to the medicine container and switch on the device to remove any medicine residue from the mesh first. (Please spray the entire liquid).
- Remove the batteries.
- Remove the detachable parts from the device, e.g. mesh nebulizer or medicine container and cover.
- The nebulizer is later reassembled in the reverse order.

Important

Never hold the complete device or nebulizer unit to clean under running water.

When cleaning, ensure that all residues are removed and dry all parts carefully. Never use any substances that may be poisonous when in contact with the skin or mucous membranes, or when swallowed or inhaled.

Important

Before you clean the device, always switch it off, unplug it and let it cool off.

Do not use abrasive detergents and never immerse the device in water.

Important

- Ensure that no water penetrates inside the device.
- Do not put the device or accessories in a dishwasher.
- Do not touch the device with wet hands while it is plugged in; do not allow any water to be sprayed onto the device. The device must be operated only when it is completely dry.

Disinfection

- First clean the nebulizer and the accessories as described in the cleaning section. You can then continue with disinfection.
- Pour 8 ml ethyl alcohol (75% v/v) into the medicine container. Close the container. Leave the alcohol in the container for at least 10 minutes.
- For better disinfection, shake the device gently from time to time.
- Afterwards, pour the ethyl alcohol out of the container.
- Repeat this process, using water this time.

Disassembly

- To continue with cleaning its individual components, disassemble the nebulizer.

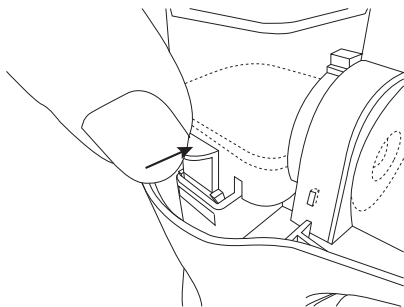

- Remove the medicine container and mesh nebulizer by pressing both brackets inwards and drawing the device out.

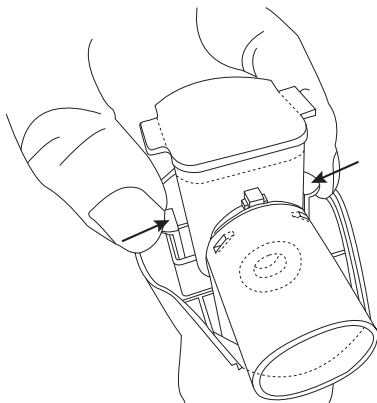

- Remove the mesh nebulizer from the medicine container by turning it clockwise and drawing it out.

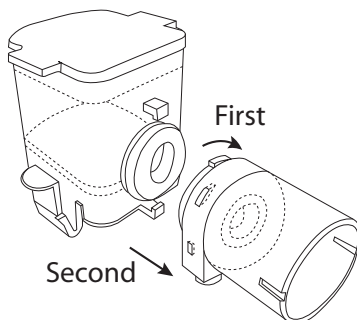

- The nebulizer is later reassembled in the reverse order.
- Finally, clean all the parts again under running water (except for the mesh nebulizer).

Important

Ensure that you do not touch the mesh, as this may destroy it. The mesh must not be rinsed under running water, otherwise the mesh may become damaged.

- If any traces of medical solutions or impurities remain on the gold-colored contacts on the device and nebulizer, use cotton buds to remove them.
- Clean the outside of the mesh and outside of the medicine container with a cotton bud.

Drying

- Place the individual components on a dry, clean and absorbent surface and allow to dry completely (for at least 2 hour).

Note:

Ensure that all parts are thoroughly dried after cleaning, otherwise there is an increased risk of bacterial growth.

Once all components are fully dried, reassemble the nebulizer and place the components in a dry, sealed container.

Material Resistance

- When choosing a cleaning or disinfecting agent, note the following:
Only use mild cleaning or disinfectant agents in the quantities recommended by the manufacturer.
- As with all plastic components, frequent use and cleaning of the accessories can lead to a certain amount of wear. Over time, this can alter the aerosol properties and may eventually affect the efficiency of therapy. We therefore recommend that you replace the nebulizer cup and accessories at least once a year.

Storage

- Do not store the nebulizer in a damp atmosphere (e.g. in the bathroom) or transport it together with damp objects.
- Store and transport the nebulizer away from direct sunlight.

How to replace the mesh nebulizer

The mesh nebulizer is a consumable part.

Drive Medical recommends to change the mesh nebulizer after approximately 1 year.

Remove the mesh nebulizer and install a new one as described on page 09 (section "Assembly").

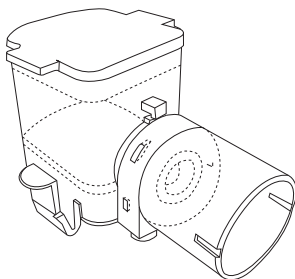

For buying new mesh nebulizer, please contact your Drive Medical equipment provider.

Troubleshooting

Problem/Question	Possible Cause/Remedy
The nebulizer produces little or no aerosol	1. Too little medicine in the nebulizer.
	2. The nebulizer is not held in an upright position.
	3. The medicine is unsuitable for spraying (e.g. too thick, highly viscous). The medicine solution should be specified by your doctor.
	4. The batteries are dead. Replace the batteries or connect the power supply unit, and try again.
	5. There are air bubbles inside the medicine container which are preventing the medicine from coming into contact with the mesh. Please check and remove any air bubbles.
	6. Particles on the mesh are inhibiting output. To remove these dirt particles, fill the nebulizer with 2-3 drops of vinegar and 3-6 ml of water then nebulize this solution completely. Please do not inhale this spray and ensure that you clean and disinfect the medicine container afterwards. If the output does not improve, replace the mesh.
	7. The mesh is worn out. Replace the mesh.
Which medicines are suitable for inhalation?	Only your doctor can advise you which medicine to use to treat your condition. Consult your physician.
Inhalation with the mask takes longer	This is for technical reasons. Less medicine is inhaled per breath through the mask holes than using the mouthpiece. The aerosol is mixed with ambient air through the holes in the mask.

Problem/Question	Possible Cause/Remedy
<p>What special steps should be taken for babies and children?</p>	<p>1. In babies, the mask should cover the mouth and nose to guarantee effective inhalation.</p> <p>2. In children, the mask should also cover the mouth and nose. It is not suitable to use the nebulizer while sleeping or lying on the bed because the medicine will not reach the lungs sufficiently.</p> <p>Note: Children should only use the device with help and under supervision of an adult. Never leave a child alone with the nebulizer.</p>
<p>Does each user need their own accessories?</p>	<p>This is absolutely necessary for hygiene reasons.</p>

Specifications

Model		18018
Particle Size		1.0 – 5.0 µm
Technology		Vibrating Mesh
Medication Container Capacity		8 ml maximum
Residual Volume		Approx. 0.1ml
Electrical	Battery	1.5V (AAA batteries ×4)
	Adapter	100V-240V / 50~60Hz / 0.15A
Power Consumption		Approx. 1.5W
Dimensions (mm)		2.75" (W) x 5.71" (H) x 2.28" (D)
Operating conditions		Temperature: 37°F ~ 122°F (3°C ~ 50°C) (no condensation) Relative humidity: Max 70% RH
Storage and transport conditions		Temperature: 14°F ~ 176°F (-10°C ~ 80°C) (no condensation) Relative humidity: Max 70% RH

<NOTE>

- Specifications may be changed without prior notice.
- Disposal of this product, the optional accessories and used batteries should be carried out in accordance with the national regulations for the disposal of electronic products. Unlawful disposal may cause environmental pollution.
- Using this device with or near other medical/electrical equipment could produce mutual interference. Be sure to read the Instruction Manual for correct installation and use. Also, be sure to read the Instruction Manuals for all other electronic equipment nearby.

Manufacture Date

According to manufacture date, please see product's CE label SN number.
The SN coding principles are as below.

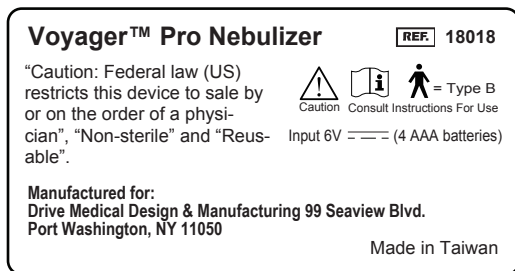

SN Coding principles :

The sequence will begin with your 2 digit factory code, followed by the 2 digit year, followed by the 2 digit month, followed by a unique set of numbers that your factory creates. This number needs to be printed on the bottom of the product, the technical label and the retail box as well.

Warranty Information

The Voyager™ Pro Nebulizer has been carefully manufactured and inspected and is warranted to be free from defectives in workmanship and materials. Under this warranty, Drive Medical's obligation shall be limited to the replacement or repair of any such units which prove, by Drive Medical's inspection, to be defective within two years from the original purchase date. This warranty is not transferrable or assignable to any subsequent purchaser or owner. Any abuse, operation other than the intended use of this product as outlined in the manual, negligence, accident, or repairs by someone other than a Drive Medical Authorized Service Professional, shall immediately void this warranty.

Drive Medical will not accept damages or charges for labor, parts, or expenses incurred in making field repairs.

The foregoing warranty is exclusive and in lieu of all other expressed warranties. Implied warranties, if any, including but not limited to the implied warranties of merchantability and fitness for a particular purpose, shall not extend beyond the duration of the express warranty provided herein. In no event shall Drive Medical or its subsidiaries be liable for loss of use or profit or other collateral, special or consequential damages.

Manufactured for:

Drive Medical Design & Manufacturing
99 Seaview Blvd. Port Washington, NY 11050

www.drivemedical.com

Copyright © 2014 Medical Depot Inc. All Rights Reserved.
Made in Taiwan



drive *for the road ahead™*

www.drivemedical.com