

3M

Littmann®  
Brand

## **Cardiology S.T.C. Stethoscope**

Soft-Touch Chestpiece

- Patented chestpiece design
- Outstanding acoustics
- Patented tunable diaphragm
- Two-tubes-in-one design
- Patented Littmann®  
Soft-sealing eartips



Congratulations on the purchase of your new 3M™ Littmann® Cardiology S.T.C. (Soft-Touch Chestpiece) Stethoscope. Designed to meet the exacting requirements of health care professionals who demand outstanding acoustic response. The Littmann Cardiology S.T.C. stethoscope is designed with a new ovoid shaped chestpiece that allows improved access to areas difficult to auscultate with traditional circular chestpieces. The new design also utilizes 3M's patented tunable diaphragm combined with superb craftsmanship to offer the ultimate performance in an outstanding single-sided stethoscope.

The Littmann Cardiology S.T.C. stethoscope has a satin polished stainless steel chestpiece offering the convenience of a single-sided stethoscope. The patented tunable diaphragm conveniently alternates between low and high frequency sounds without the need to rotate the chestpiece. Additionally, the stethoscope features a "Soft-Touch" insert for improved ergonomics. Other features include a patient-friendly non-chill rim and diaphragm, excellent acoustic seal and comfortable fit with patented 3M™ Littmann® Snap Tight soft-sealing eartips, and a comfortably angled, anatomically correct headset. The Littmann Cardiology S.T.C. stethoscope also offers a two-in-one tube design to eliminate tube-rubbing noise, and is available in a selection of classic tube colors to meet individual preferences.

Most of all know that your Littmann Cardiology S.T.C. stethoscope carries the Littmann brand name, the name known worldwide for unsurpassed quality. As a trusted leader in auscultation technology, the Littmann brand of stethoscopes is your assurance of acoustical superiority, innovative design and exceptional performance.

## Indications

This device is intended for medical diagnostic purposes only. It can be used for auscultation of heart, lung and other body sounds. This product is not designed, sold or intended for use except as indicated.

## Instructions for Use:

Gripping of the stethoscope and Changing Frequencies Using the Tunable Diaphragm

The Littmann Cardiology S.T.C. allows for a variety of auscultation styles. Grasp the stethoscope chestpiece as you are most comfortable, either two or three finger style. Your Littmann Cardiology S.T.C. stethoscope is equipped with a patented tunable diaphragm that enables you to listen to both low and high frequency sounds without rotation of the chestpiece.

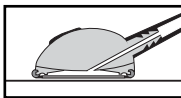

*Low frequencies:* To listen to low frequency sounds (traditional bell mode) use very light

pressure on skin contact or lay the chest piece over the area of auscultation.

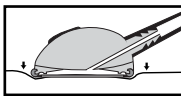

*High frequencies:* To listen to high frequency sounds (traditional diaphragm mode), press firmly

on the chestpiece. To listen to low and high frequency sounds without removing and repositioning the chestpiece simply alternate between light and firm hand pressure on the chestpiece.

## Headset Adjustment:

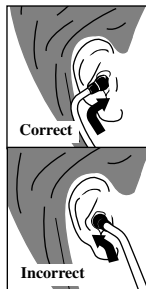

Your new Littmann stethoscope is designed to provide a comfortable acoustically sealed ear fit. Notice that the ear-tubes are set to accommodate the typical anatomy of the ear canal. The eartips should point in a forward direction as you insert them into your ear canals.

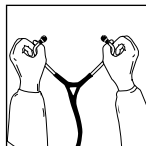

To reduce spring tension in the headset, hold each ear-tube at the bend near the eartip and gradually pull apart until fully extended.

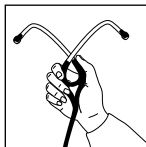

To increase spring tension, grasp the headset with one hand where the ear-tubes enter the plastic tubing and squeeze until the plastic tubing on one ear-tube touches the other. Repeat as necessary.

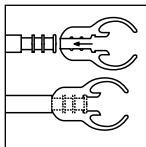

For maximum acoustic performance, comfortable patented 3M™ Littmann® Soft-sealing Eartips are provided with your stethoscope. This stethoscope utilizes a unique design for

attaching the eartip to the ear-tube. The eartips are pushed on to the end of the ear-tube and

snapped firmly into place. To remove, pull firmly on the eartip.

## Removing the Diaphragm and Cleaning the Chestpiece:

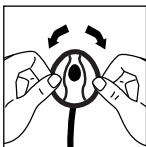

With the diaphragm side up, push the rim at the apex with both thumbs and roll the rim off the edge of the chestpiece. Remove the diaphragm from the rim and clean parts in soapy water or

wipe with alcohol. Wipe chestpiece surfaces with alcohol or soapy water. Dry all parts and surfaces thoroughly before reassembling.

## Assembly and Replacement of the Tunable Diaphragm:

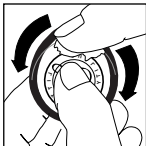

Using your fingertip, apply a small amount of talcum powder to the inside surface of the flexible edge of the diaphragm then align the rim and diaphragm as a unit. This will facilitate assembly and maintain smooth and quiet low/high frequency alternation. Snap the diaphragm with your fingers to remove excess talcum powder. Insert the flexible edge of the diaphragm into the groove of the rim. This is best accomplished by starting with the rim positioned above the legible side of the

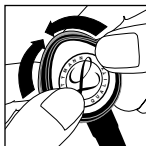
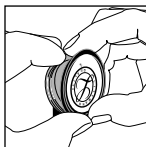
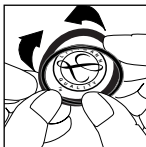

diaphragm. Visually examine the ring to ensure that the flexible edge is smoothly engaged inside the rim. Refer to illustration for correct assembly of the non-chill rim and diaphragm. If necessary, flex the assembly by pinching the outer rim edge between the thumb and fingers. To attach the rim/diaphragm assembly to the chestpiece, engage the groove of the rim (with the diaphragm attached) around the chestpiece at one point and hold it in place with your thumbs. Slowly roll the rim around and over the chestpiece edge using both thumbs, moving in opposite directions around the chestpiece. Visually inspect the edge where the diaphragm engages the rim for uniform containment.

Minor adjustments may be made by slightly pulling and rolling the rim away from the diaphragm, allowing the diaphragm to slip into position.

## General Use and Maintenance:

- Avoid extreme heat, cold, solvents, and oils.
- The entire stethoscope can be wiped clean with alcohol or soapy water.
- Eartips can be removed from the ear-tubes for thorough cleaning.

**NOTE:** Do not immerse your stethoscope in any liquid or subject it to steam sterilization. If disinfection is required, the stethoscope may be wiped with a 70% isopropyl alcohol solution.

## **Littmann Stethoscope Service and Warranty Program:**

Your Littmann stethoscope comes with the finest service and warranty policy in the industry. The Littmann Cardiology S.T.C. stethoscope is warranted against any defects in material and workmanship for a period of six (6) years. If a material or manufacturing defect is discovered during the warranty period, repairs will be made without charge upon the return of the instrument to 3M, except in cases of obvious abuse or accidental damage.

For maintenance or repair services, write a short note explaining the repair or service you require, include your name, address and phone number and send your stethoscope directly to:

3M Health Care Service Center  
Bldg. 502, Suite 200  
3350 Granada Ave. North  
Oakdale, MN 55128  
1-800-292-6298

### **IN CANADA:**

3M Health Care Service Center  
3M Canada Inc.  
80 Enterprise Drive South  
London, Ontario  
Canada N6N1C2  
1-800-563-2921

Outside of the U.S. and Canada please contact your local 3M subsidiary for maintenance and repair information.

## **Explanation of Symbols:**



• Attention, see instructions for use.



• This product and package do not contain natural rubber latex.



Made in USA by **3M Health Care**, St. Paul, MN 55144-1000  
(U.S.A.) 1-800-228-3957 • Fax 651-736-2803  
Visit our web site: <http://www.3M.com/Littmann>

**CE**  Attention, see instructions for use.  
**3M Health Care** D-41453 Neuss, Germany

3M is a trademark of 3M.  
Littmann is a registered trademark of 3M.

38-9017-6966-1